

FREEHOLD



House - Semi-Detached

12 SPRINGWELL AVENUE, LIVERPOOL, L36 9AD

Asking Price

£250,000

FEATURES

- Beautifully presented three bedroom semi detached
- Entrance hall and downstairs cloaks
- Modern fitted kitchen with built in appliances
- Family bathroom with a three piece suite
- Situated on a modern development
- Lounge/Dining room with french doors to the garden
- En suite to the main bedroom with shower enclosure
- Garden at the rear and double driveway at the front



3



2



1



B



BROOKS
ESTATE AND LETTING AGENTS LTD

3 Bedroom House - Semi-Detached located in Liverpool

A beautifully presented three bedroom semi detached property situated on a modern development and close to local schools, shops and transport links. The accommodation briefly comprises of entrance hall, downstairs cloaks, lounge with french doors to the garden and a modern fitted kitchen with quality units and built in appliances. On the first floor are three bedrooms with an en suite shower room to the main bedroom and a further family bathroom. The property has a garden at the rear and a double driveway at the front. We recommend an early viewing of this lovely family home. EPC GRADE: B

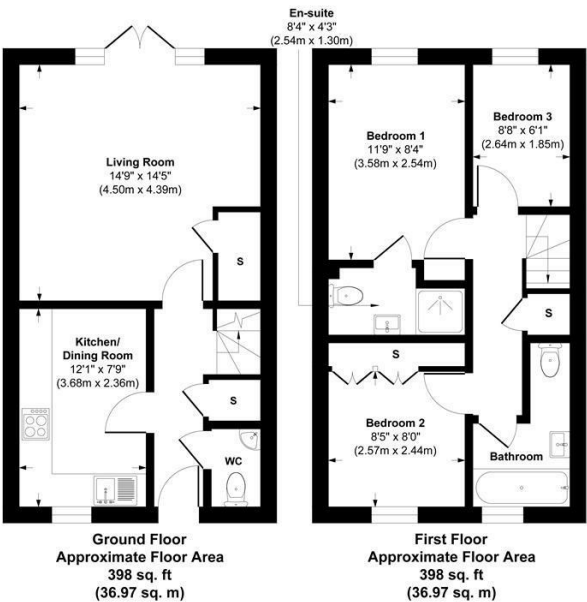

Approx. Gross Internal Area 796 sq. ft / 73.94 sq. meters
Whilst every attempt has been made to ensure the accuracy of the floorplan shown, all measurements, positioning fixtures fittings and any other data shown are an approximate interpretation for illustrative purposes only and are not to scale. No responsibility is taken for any errors, omission, mis-statement or use of data show.

Call us on
0151 329 3313
prescot@brooksestateandlettings.co.uk
www.brooksestateandlettings.co.uk

Council Tax Band
B

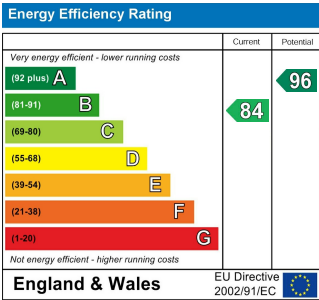

Agents Note: Whilst every care has been taken to prepare these particulars, they are for guidance purposes only. All measurements are approximate and are for general guidance purposes only and whilst every care has been taken to ensure their accuracy, they should not be relied upon and potential buyers are advised to recheck the measurements.

